

Soils Map

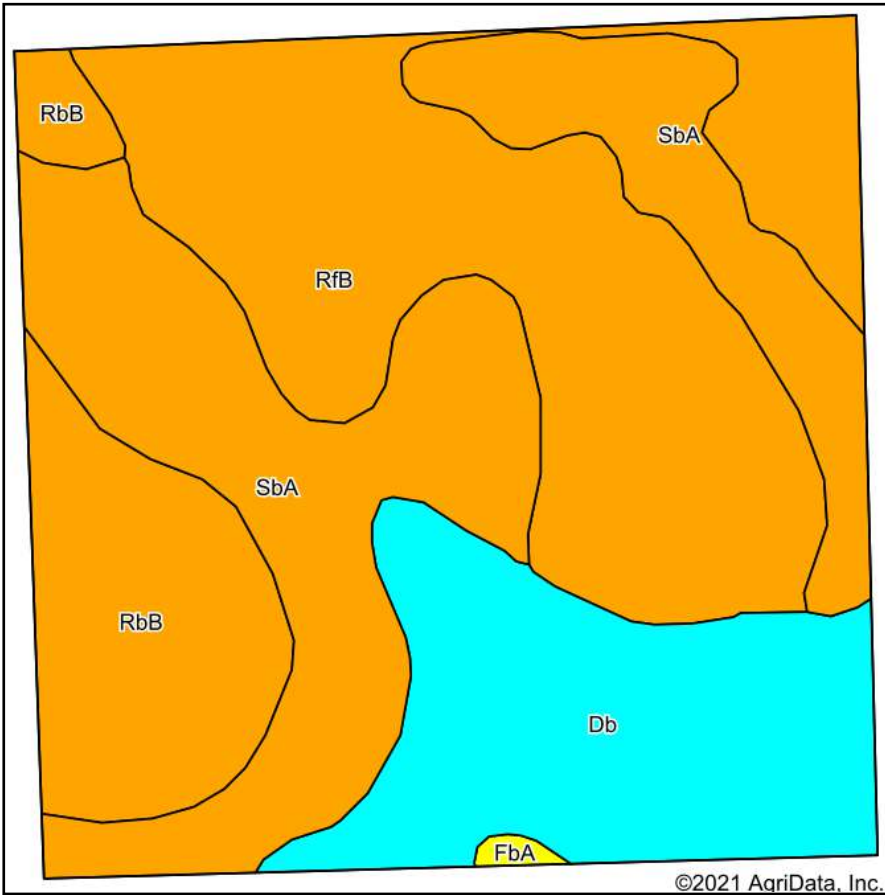

Soils data provided by USDA and NRCS.

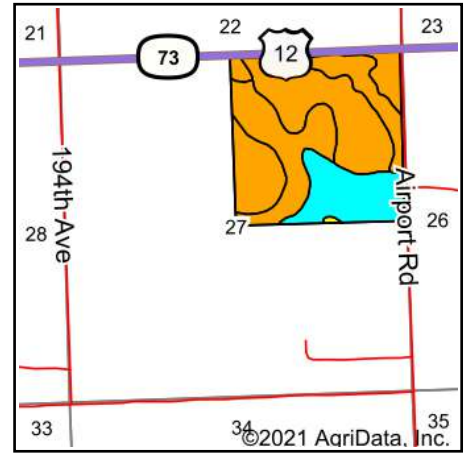

State: **South Dakota**
 County: **Perkins**
 Location: **27-23N-16E**
 Township: **Lincoln**
 Acres: **155.54**
 Date: **4/9/2021**



Maps Provided By:



Area Symbol: SD105, Soil Area Version: 20

Code	Soil Description	Acres	Percent of field	PI Legend	Non-Irr Class *c	Productivity Index
RfB	Regent-Savage silty clay loams, 3 to 6 percent slopes	54.04	34.7%		Ile	79
SbA	Savage-Daglum complex, 0 to 2 percent slopes	49.36	31.7%		Ilc	72
Db	Dimmick and Heil soils	30.50	19.6%		Vs	22
RbB	Reeder-Amor loams, 2 to 6 percent slopes	21.17	13.6%		Ile	79
FbA	Farnuf-Daglum loams, 0 to 2 percent slopes	0.47	0.3%		Ilc	70
Weighted Average						65.6

*c: Using Capabilities Class Dominant Condition Aggregation Method
 Soils data provided by USDA and NRCS.