

Soils Map

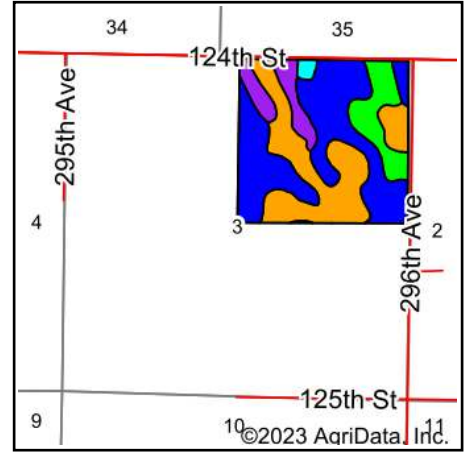

State: **South Dakota**
 County: **Walworth**
 Location: **3-124N-78W**
 Township: **West Walworth**
 Acres: **146.33**
 Date: **6/19/2023**

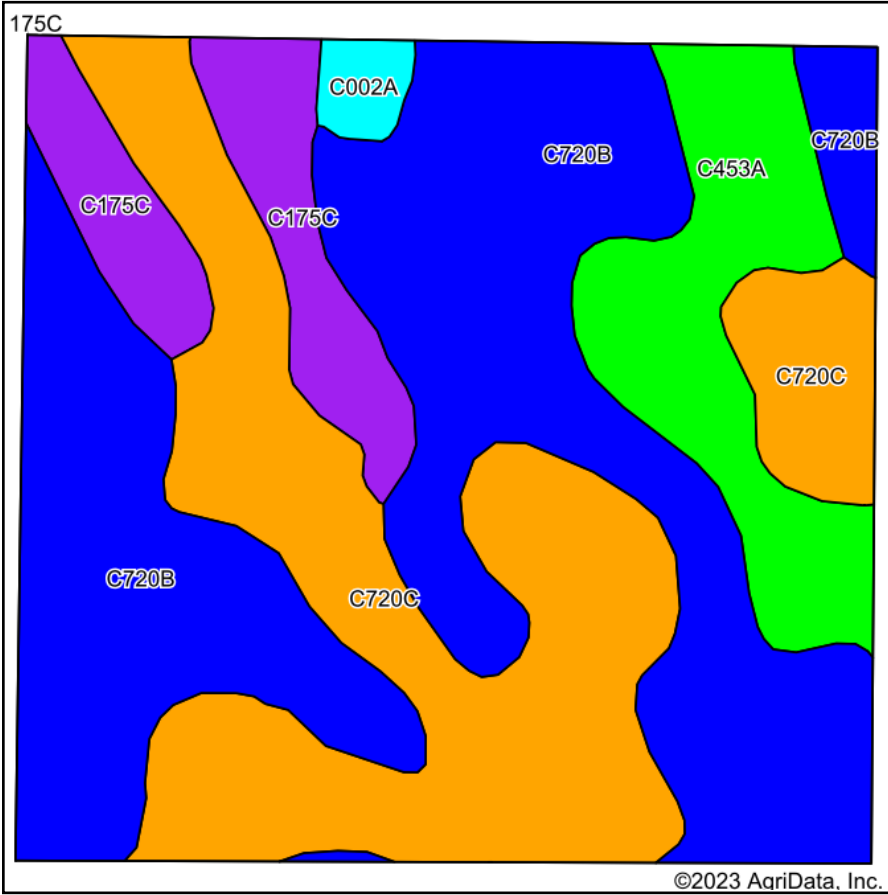

Maps Provided By:



Soils data provided by USDA and NRCS.

Area Symbol: SD021, Soil Area Version: 28
 Area Symbol: SD129, Soil Area Version: 25

Code	Soil Description	Acres	Percent of field	PI Legend	Non-Irr Class *c	Productivity Index
C720B	Highmore silt loam, cool, 2 to 6 percent slopes	67.74	46.3%		Ile	82
C720C	Highmore silt loam, cool, 6 to 9 percent slopes	46.43	31.7%		IIIe	73
C453A	Mobridge silt loam, cool, 0 to 2 percent slopes	17.18	11.7%		IIc	93
C175C	Zahl-Williams-Zahill complex, 6 to 9 percent slopes	13.19	9.0%		IVe	56
C002A	Tonka silt loam, 0 to 1 percent slopes	1.79	1.2%		IVw	45
Weighted Average					2.52	77.6

*c: Using Capabilities Class Dominant Condition Aggregation Method
 Soils data provided by USDA and NRCS.