

Soils Map

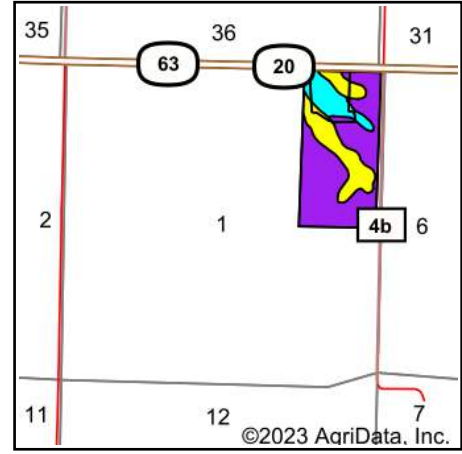

State: **South Dakota**
 County: **Dewey**
 Location: **1-17N-25E**
 Township: **North Dewey**
 Acres: **75.27**
 Date: **7/17/2023**

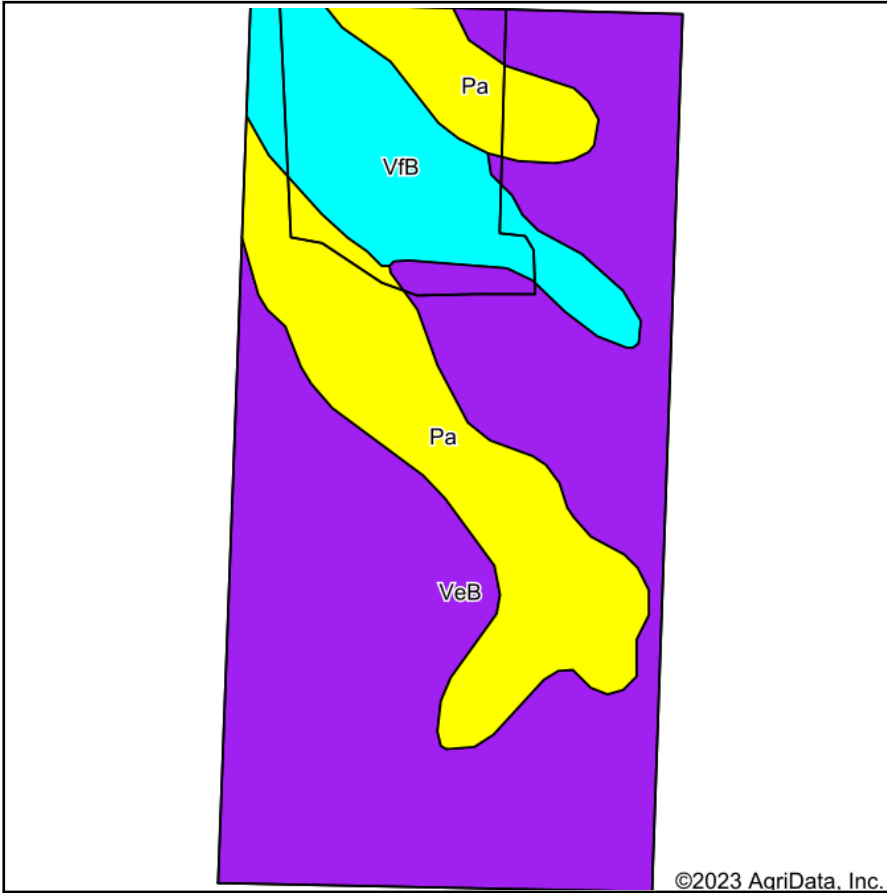

Maps Provided By:



Soils data provided by USDA and NRCS.

©2023 AgriData, Inc.

Area Symbol: SD041, Soil Area Version: 27

Code	Soil Description	Acres	Percent of field	PI Legend	Non-Irr Class *c	Irr Class *c	Productivity Index
VeB	Vebar fine sandy loam, 3 to 6 percent slopes	47.10	62.6%		IIIe	IIIe	54
Pa	Parshall fine sandy loam	18.13	24.1%		IIIe		63
VfB	Vebar-Flasher complex, 2 to 9 percent slopes	10.04	13.3%		IVe		34
Weighted Average					3.13	*-	53.5

*c: Using Capabilities Class Dominant Condition Aggregation Method

*- Irr Class weighted average cannot be calculated on the current soils data due to missing data.

Soils data provided by USDA and NRCS.