

Soils Map

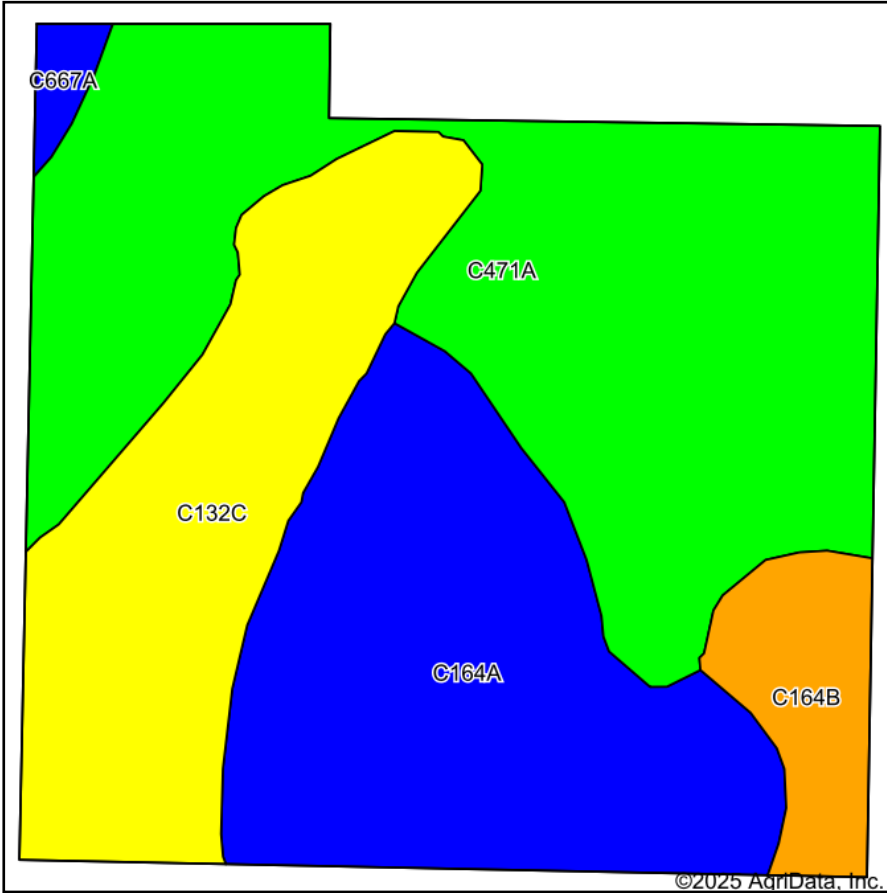

Soils data provided by USDA and NRCS.

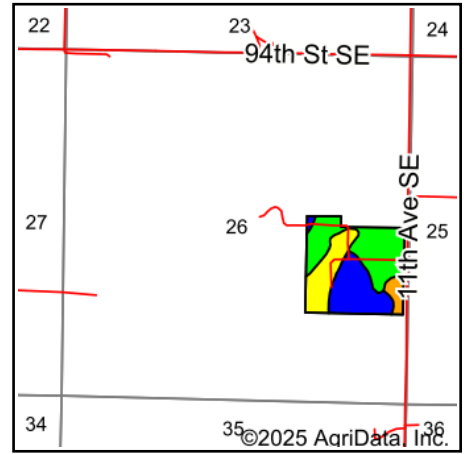

State: **North Dakota**
 County: **Emmons**
 Location: **26-130N-76W**
 Township: **South Emmons**
 Acres: **46.95**
 Date: **1/14/2025**



Maps Provided By:



© AgriData, Inc. 2023

www.AgriDataInc.com



Area Symbol: ND029, Soil Area Version: 29

Code	Soil Description	Acres	Percent of field	PI Legend	Non-Irr Class *c	Productivity Index
C471A	Grail silty clay loam, 0 to 2 percent slopes	19.93	42.5%		IIc	95
C164A	Williams-Falkirk loams, 0 to 3 percent slopes	13.43	28.6%		IIc	85
C132C	Williams-Zahl-Zahill complex, 6 to 9 percent slopes	10.37	22.1%		IIIe	61
C164B	Williams-Falkirk loams, 3 to 6 percent slopes	2.73	5.8%		IIe	79
C667A	Williams-Niobell loams, 0 to 3 percent slopes	0.49	1.0%		IIc	81
Weighted Average					2.22	83.6

*c: Using Capabilities Class Dominant Condition Aggregation Method