

# Soils Map

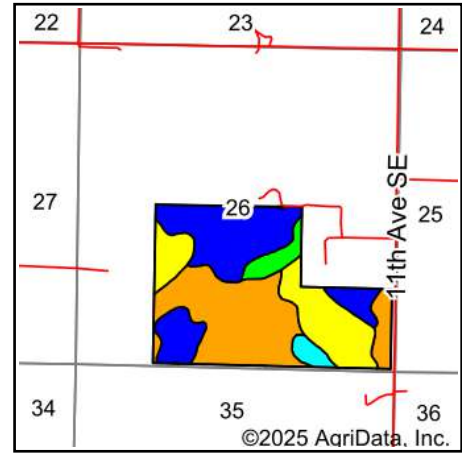

State: **North Dakota**  
 County: **Emmons**  
 Location: **26-130N-76W**  
 Township: **South Emmons**  
 Acres: **190.13**  
 Date: **1/17/2025**

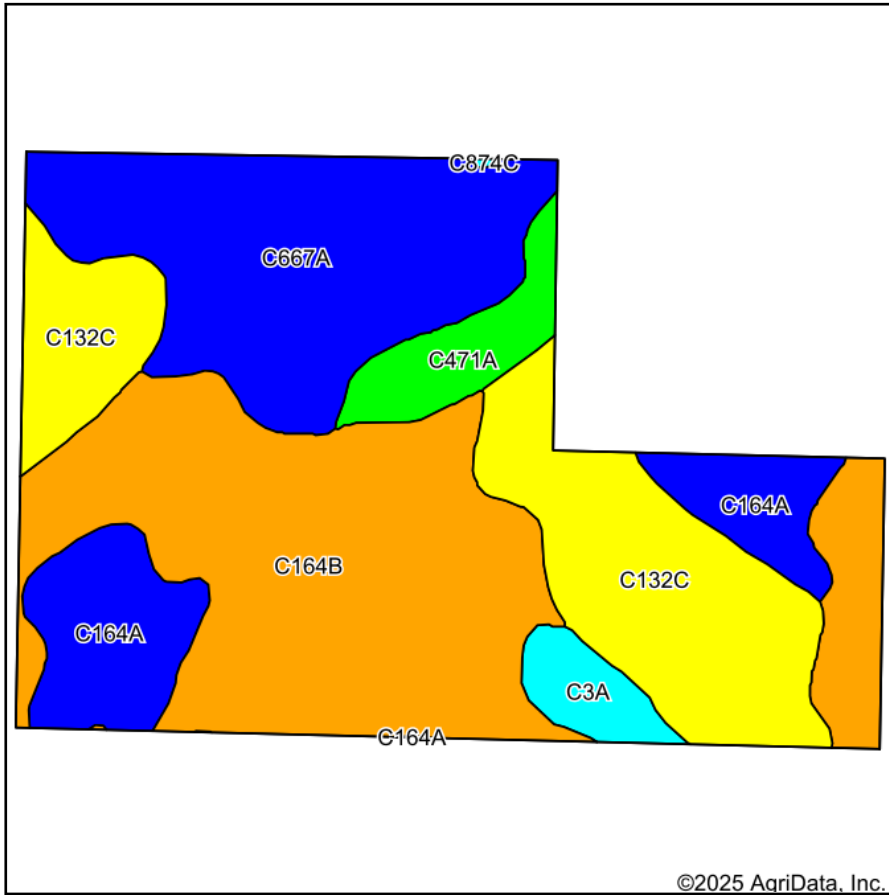

Maps Provided By:



Soils data provided by USDA and NRCS.

©2025 AgriData, Inc.

© AgriData, Inc. 2023

www.AgriDataInc.com

Area Symbol: ND029, Soil Area Version: 29

Code	Soil Description	Acres	Percent of field	PI Legend	Non-Irr Class *c	Productivity Index
C164B	Williams-Falkirk loams, 3 to 6 percent slopes	71.63	37.8%		Ile	79
C667A	Williams-Niobell loams, 0 to 3 percent slopes	43.24	22.7%		IIc	81
C132C	Williams-Zahl-Zahill complex, 6 to 9 percent slopes	41.29	21.7%		IIIe	61
C164A	Williams-Falkirk loams, 0 to 3 percent slopes	20.30	10.7%		IIc	85
C471A	Grail silty clay loam, 0 to 2 percent slopes	8.43	4.4%		IIc	95
C3A	Parnell silty clay loam, 0 to 1 percent slopes	5.16	2.7%		Vw	20
C874C	Wabek-Appam complex, 6 to 9 percent slopes	0.08	0.0%		VIIs	26
<b>Weighted Average</b>					<b>2.30</b>	<b>75.3</b>

\*c: Using Capabilities Class Dominant Condition Aggregation Method

Soils data provided by USDA and NRCS.